

Honeywell

SMART START INSTRUCTIONS

! ALL USERS MUST READ AND UNDERSTAND OWNER'S MANUAL!

1 MOVE GENERATOR OUTSIDE

2 CHECK FUEL LEVEL

3 CHECK OIL LEVEL

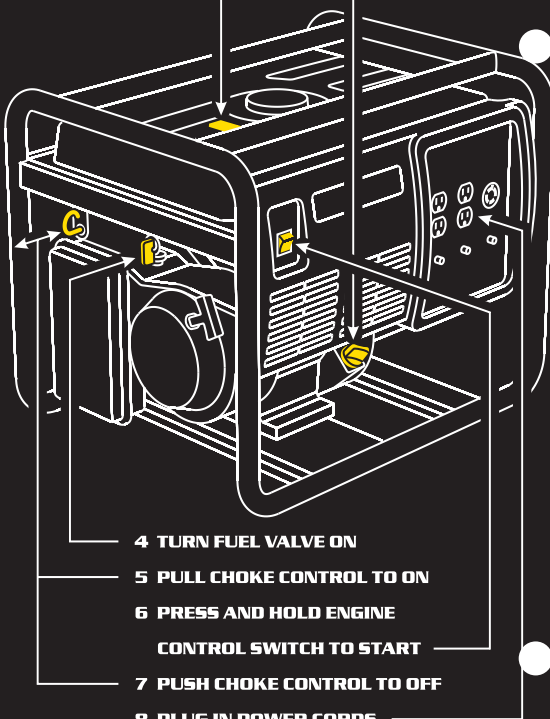

4 TURN FUEL VALVE ON

5 PULL CHOKE CONTROL TO ON

6 PRESS AND HOLD ENGINE

CONTROL SWITCH TO START

7 PUSH CHOKE CONTROL TO OFF

8 PLUG IN POWER CORDS

STOPPING INSTRUCTIONS

1 UNPLUG ALL POWER CORDS

2 RUN UNIT 2-3 MINUTES

3 PRESS ENGINE CONTROL TO STOP

4 TURN FUEL VALVE OFF

FOR 24 HOUR STARTING INSTRUCTIONS CALL

1-888-RECOIL-8
(732-6458)